

Skeel Lecture Theatre

Contact Details	Phone	email
Security Emergency number General enquiries	3333 5000	mile-end-security@qmul.ac.uk
Audio Visual / Lecture Capture Technical assistance/faults Audio visual bookings Lecture capture bookings	6550 8888 8164	servicedesk@qmul.ac.uk servicedesk@qmul.ac.uk qreviewbookings@qmul.ac.uk
Maintenance / Cleaning / Porters	2580	eaf-helpdesk@qmul.ac.uk
Room Bookings Room booking enquiries Events and Hospitality Office	8162 8175	timetabling@qmul.ac.uk https://WebRoomBookings.qmul.ac.uk enquiries@qmhospitality.co.uk



Please note that the external prefix to all internal numbers is 020 7882

The fire evacuation meeting point for this building is
Assembly Point B, Geography Square

Room Details	Capacity – 247 (fixed)
General Equipment	247 Fixed Seats, Teaching Desk, Lectern, Phone
Audio Visual Equipment	2 Data Projectors, PC, HDMI/VGA Laptop Inputs, DVD, VHS, Visualiser, PA, 2 Screens, 4 Whiteboards, Lecture Capture

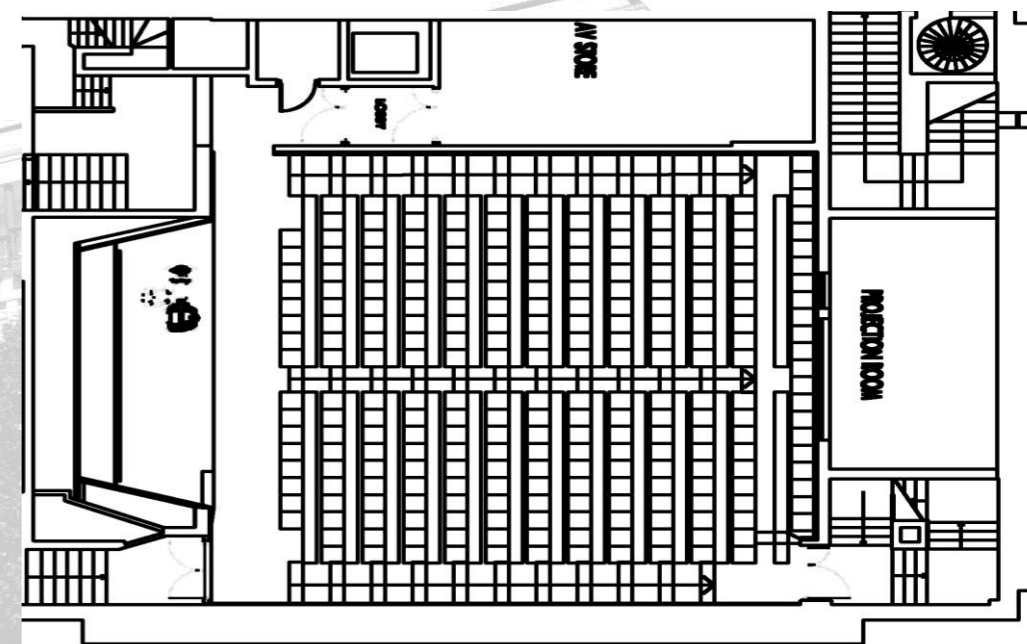

No food and drink. Please replace furniture.

PP1

Contact Details	Phone	email
Security Emergency number General enquiries	3333 5000	mile-end-security@qmul.ac.uk
Audio Visual / Lecture Capture Technical assistance/faults Audio visual bookings Lecture capture bookings	6550 8888 8164	servicedesk@qmul.ac.uk servicedesk@qmul.ac.uk qreviewbookings@qmul.ac.uk
Maintenance / Cleaning / Porters	2580	eaf-helpdesk@qmul.ac.uk
Room Bookings Room booking enquiries Events and Hospitality Office	8162 8175	timetabling@qmul.ac.uk https://WebRoomBookings.qmul.ac.uk enquiries@qmhospitality.co.uk



Please note that the external prefix to all internal numbers is 020 7882

The fire evacuation meeting point for this building is
Assembly Point B, Geography Square

Room Details	Capacity – 105 (fixed)
General Equipment	105 Fixed Seats, Teaching Desk, Lectern, Phone
Audio Visual Equipment	2 Data Projectors, PC, HDMI/VGA Laptop Inputs, DVD, VHS, Visualiser, PA, 2 Electric Screens, 3 Whiteboards, Lecture Capture

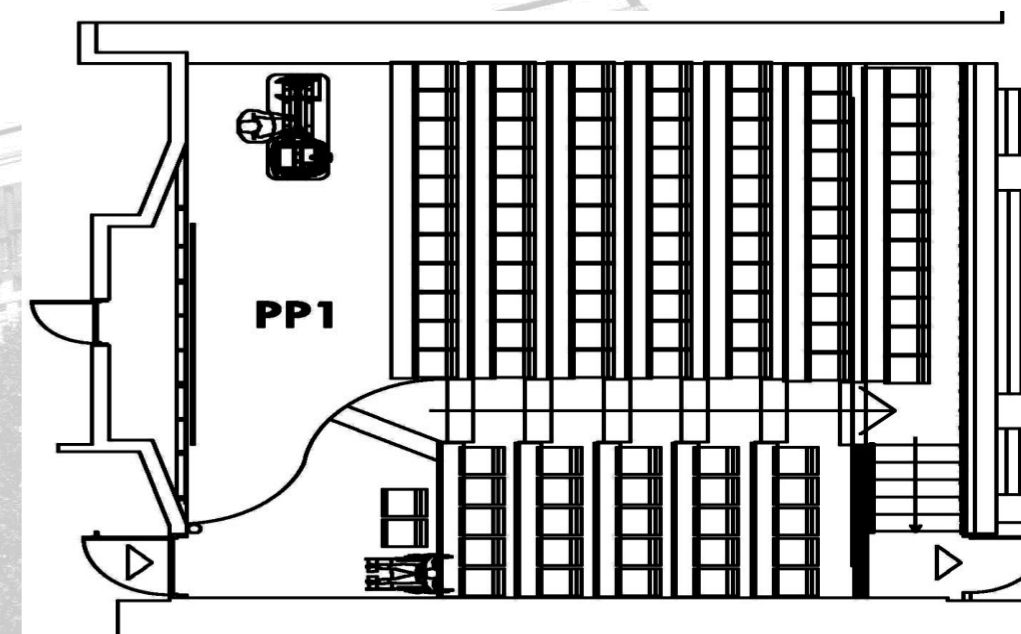

No food and drink. Please replace furniture.

PP2

Contact Details	Phone	email
Security Emergency number General enquiries	3333 5000	mile-end-security@qmul.ac.uk
Audio Visual / Lecture Capture Technical assistance/faults Audio visual bookings Lecture capture bookings	6550 8888 8164	servicedesk@qmul.ac.uk servicedesk@qmul.ac.uk qreviewbookings@qmul.ac.uk
Maintenance / Cleaning / Porters	2580	eaf-helpdesk@qmul.ac.uk
Room Bookings Room booking enquiries Events and Hospitality Office	8162 8175	timetabling@qmul.ac.uk https://WebRoomBookings.qmul.ac.uk enquiries@qmhospitality.co.uk



Please note that the external prefix to all internal numbers is 020 7882

The fire evacuation meeting point for this building is
Assembly Point B, Geography Square

Room Details	Capacity – 105 (fixed)
General Equipment	105 Fixed Seats, Teaching Desk, Lectern, Phone
Audio Visual Equipment	2 Data Projectors, PC, HDMI/VGA Laptop Inputs, DVD, VHS, Visualiser, PA, 2 Electric Screens, 3 Whiteboards, Lecture Capture

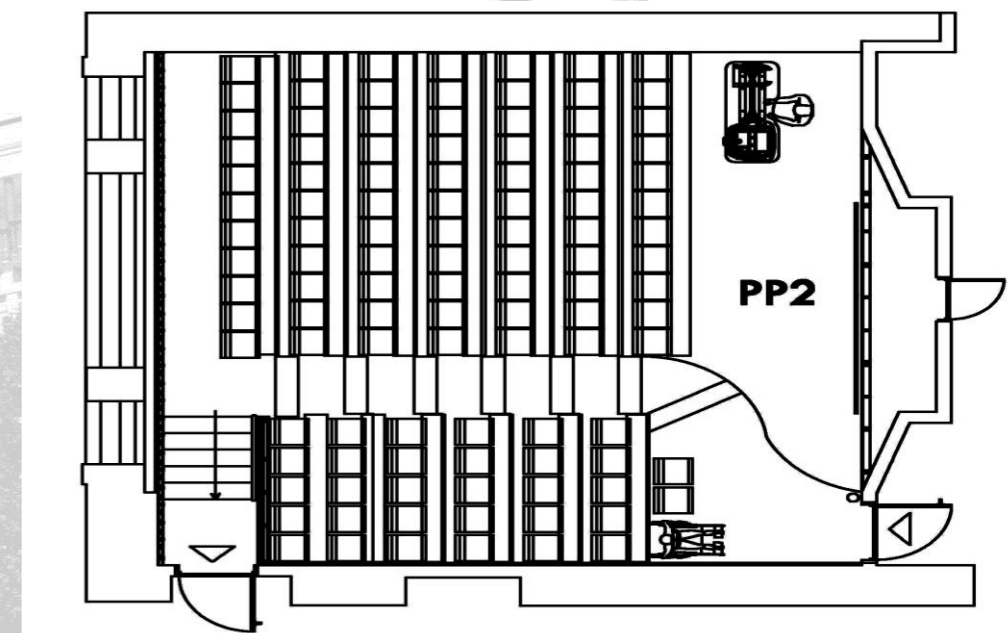

No food and drink. Please replace furniture.